

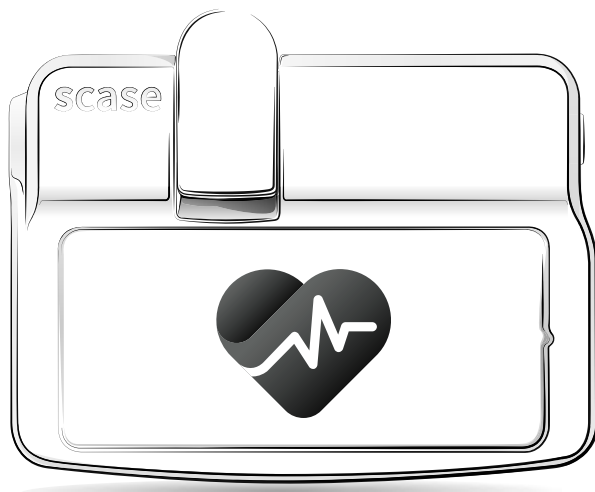

User Manual

www.scase.io/manuals/





User manual

Thank you
For your participation

⚠ Not intended for diagnostic use, nor prevention of disease

This device is provided under the Medical Device Directive COUNCIL DIRECTIVE 93/42/EEC of 14 June 1993 concerning medical devices under the Articles 4, 15 and Annex VII for Free movement, devices intended for special purposes

1. About Scase Device	1
2. Add & search a patient	1
Add a patient.....	1
3. Patient Database screen	2
Notes	2
Measurements history	3
No previous measurements	3
4. Thermometer	5
Taking Temperature	5
5. Pulse oximeter	7
Taking Oxygen Saturation & Pulse Measurement	7
To start a Pulse oximeter measurement	7
6. Blood pressure monitor	9
Taking Blood pressure measurement.....	9
To start a Blood pressure measurement,.....	9
7. Glucometer	10
Test Strip.....	10
Lancing Device.....	10
Preparing the Lancing device	11
Taking Blood glucose measurement.....	12
To start a Blood glucose measurement	12
8. Device description	16
9.Customer Support	18
Website link	18
QR code.....	18

1. About Scase Device

Scase Device is intended to be used for measuring, displaying, reviewing, and storing of Blood pressure, Oxygen saturation, Pulse rate, Blood glucose levels, Temperature of forehead or objects at home or in healthcare facilities. Values are saved automatically.

2. Add & search a patient

Add a patient

1. By clicking **Add** on the **Patient Database screen**, you can easily record a patient to the Patient Database.



2. Simply type **identification number, code or name** of the patient to the column.



- Back** - return to the **Patient Database** screen.
- Checkmark** - confirm information and record patient to **Patient Database**. After this, you will be transferred to the **Patient Database** screen. patient has been already recorded to the **Patient Database**, try to search this patient via **Search function**.

Search a patient

By clicking on the Patient Database screen, it is possible to quickly search for a chosen patient in the Patient Database.

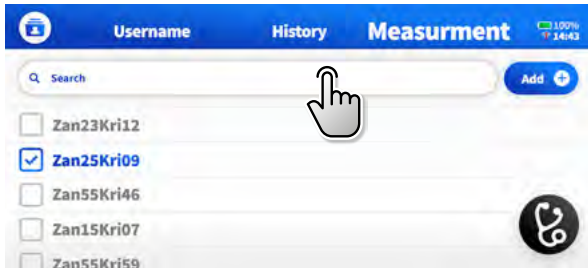

3. Patient Database screen

Once the patient is chosen, there are three major sections (**Notes, Measurements history & Measurements**) that can be explored over the profile of every patient.

Notes

1. By clicking on patient number, code or name **on the left corner** of top panel of the **Patient Database** screen, you can add a unique note for each patient.



2. At the Notes section, you can read and add notes regarding the patient health status. Notes are sorted from newest to oldest ones.



- add a new note.



- return to the **Patient Database** screen.

Measurements history

1. By clicking on History located at the top panel of **Patient Database** screen, you can explore **recent measurements of chosen patient**.



2. Measurements history is divided into **4 categories** based on the **type of measurement** which was made.



No previous measurements





If there were no measurements taken, picture above will be shown.



Previous measurements

All taken measurements are displayed in form of interactive graphs. Measurements are divided into **4 categories** based on the type of measurement which was made:



-  - **Temperature** Measurement history.
-  - **Blood glucose** Measurement history.
-  - **Blood pressure** Measurement history.
-  - **Oxygen saturation** Measurement history.

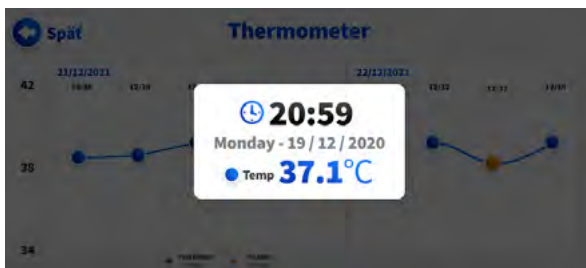

By clicking on the dot, details of a particular measurement are displayed.
- return to the Measurements history.

4. Thermometer

Taking Temperature

Measurement

To start a temperature measurement,



1. In the **Measurement screen**, select **Thermometer** button.
2. Click **Start**, Temperature Measurement starts after a short beep.



 **Back** – return to the Measurement screen.

 **History** – all previous measurements displayed.

3. Move Scase device / **Thermometer sensor** towards the middle of the patient's forehead, keep the device in horizontal position and wait until a single circle on the forehead is illuminated.
Hold still. The circle marks the ideal measurement distance.



4. Keep the sensor in the middle of the forehead. During the measurement, on the display, a **circle is slowly filled up**. Once the **measurement is concluded**, you will hear a **short beep**.

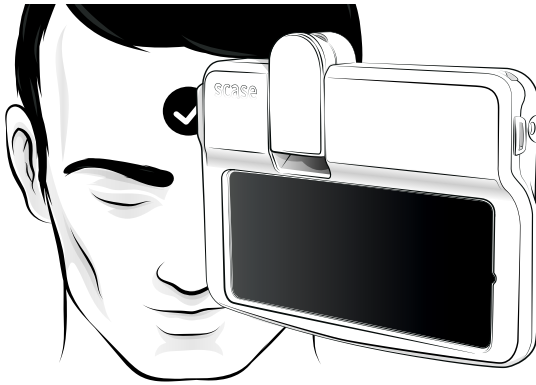

Temperature measurement taken on yourself:

Locate the Thermometer placed **on the left side of Scase Device** in the **middle of your forehead**.

5. Take down the device, the screen shows the **measurement results** in °C. Please note, you can discard the measurement by pressing  **Cancel measurement** **Measurement** can be **discarded** within 10 second, until you hear a short beep.

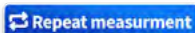

Repeat Measurement – pressing the button, you can repeat the measurement.



Back – return to the Measurement screen.



History – all previous measurements displayed.

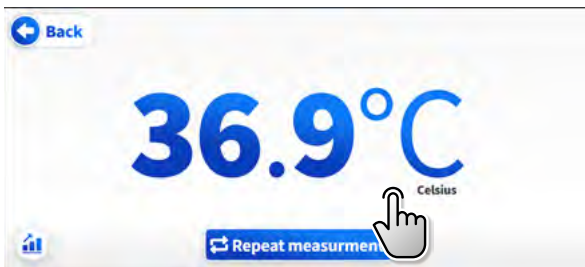

5. Pulse oximeter

Taking Oxygen Saturation & Pulse Measurement

To start a Pulse oximeter measurement

1. In the **Measurement** screen, select **Pulse oximeter** button.



2. Open the **Pulse oximeter clamp** and place the middle, ring or index finger into the rubber opening of the Pulse oximeter. **Nail of the finger must point upwards as in picture.**

△ Woman with small hands should use thumb

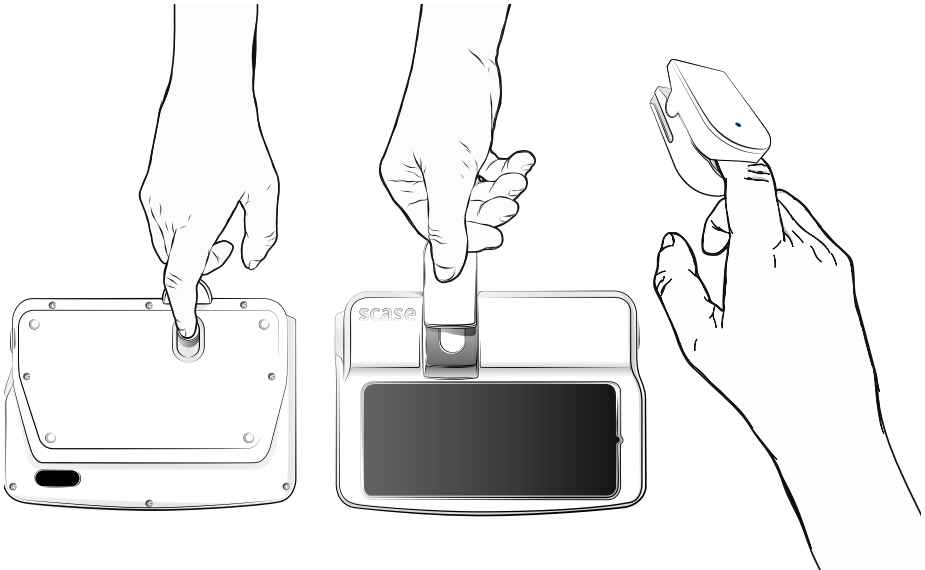

3. Click **Start**, oxygen saturation measurement starts after a short beep.



Back – return to the Measurement screen.



History – all previous measurements displayed.



Note - Keep your hand still during the measurement.



4. During the measurement, on the display, a **circle is slowly filled up**.
Once the **measurement is concluded**, you will hear a short beep.

5. The screen shows the measurement results. Please note, you can **discard the measurement** by pressing Cancel measurment Measurement can be discarded within 10 second, until you hear a short beep.



Repeat measurement

Repeat Measurement – pressing the button, you can repeat the measurement.



Back – return to the Measurement screen.



History – all previous measurements displayed.



6. Blood pressure monitor

Taking Blood pressure measurement

To start a Blood pressure measurement,

1. **Wrap the cuff** around the upper **arm** and **plug the cuff cable** to the Air Jack.

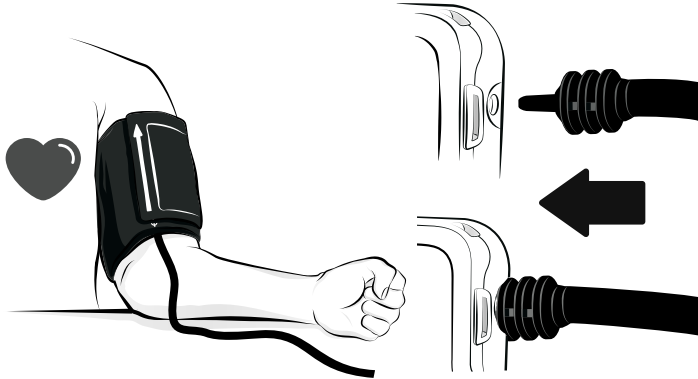

2. In the **Measurement** screen, click the **Blood pressure monitor** button.



3. For **starting** the measurement, tap the **Start icon**.





Back – return to the Measurement screen.



History – all previous measurements displayed.

4. **Measurement starts** after a short beep and the **pump begins to inflate the cuff.**
5. During the measurement, on the display, a **circle is slowly filled up.** Once the **measurement is concluded, you will hear a short beep.**
6. The screens shows the measurement results. Please note, you can **discard your measurement** by pressing **Cancel measurement** Measurement can be discarded within 10 second, until you hear a short beep.



Repeat Measurement – pressing the button, you can repeat the measurement.



Back – return to the Measurement screen.



History – all previous measurements displayed.

7. Glucometer

Test Strip

Electrode end:

This end inserted into the test strip port on the device facing up



Sample tip:

Where the blood is drawn in

Lancing Device

Lancing device cover:

Release button

Cocking barrel

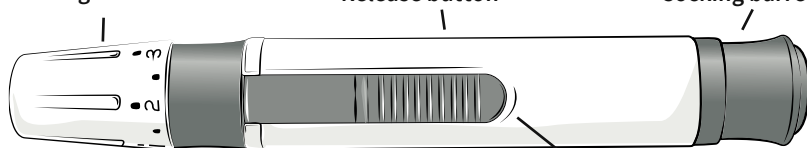

Puncture depth

Ejection button

Sterile lancet

Safety tab

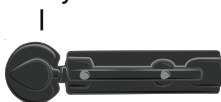

Preparing the Lancing device

1. **Unscrew the Lancing device cover** from the body of the Lancing device.
Insert a sterile lancet into the Lancing device.

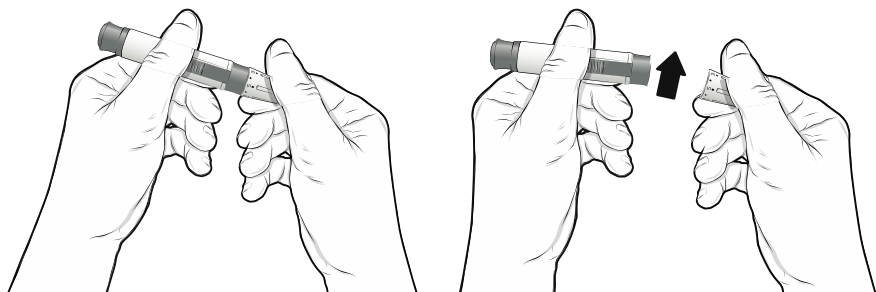

2. Hold the lancet firmly in the Lancing device and **twist the safety tab of the lancet until it loosens**, then pull the safety tab off the lancet.

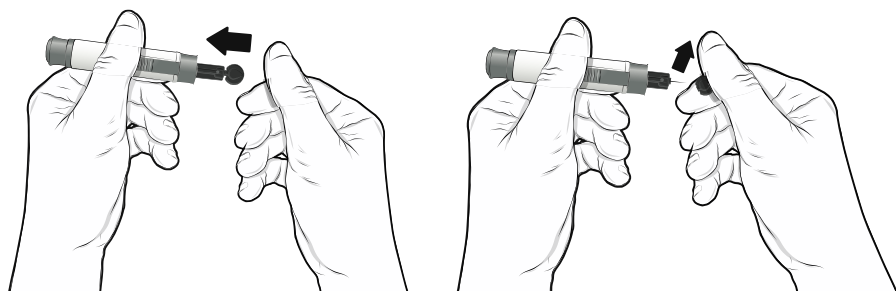

3. Carefully **screw the cover back onto** the Lancing device.

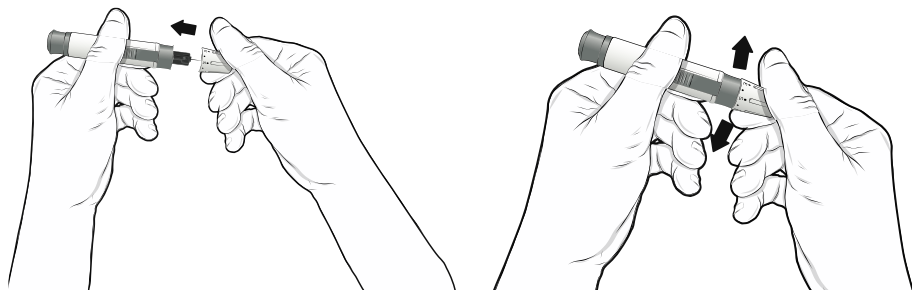

4. Adjust the **puncture depth by rotating** the Lancing device cover.

5. Pull the **cocking barrel back** to set the Lancing device.

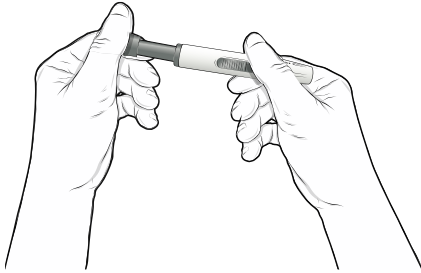

Taking Blood glucose measurement

⚠ Important: **Prior to testing, wipe the test site with an alcohol swab or soapy water. Use warm water to increase blood flow if necessary. Then dry your hands and test site thoroughly.**

To start a Blood glucose measurement

1. In the **Dashboard**, click the **Glucometer** button.



2. Follow the steps regarding **preparing the Lancing device** above.

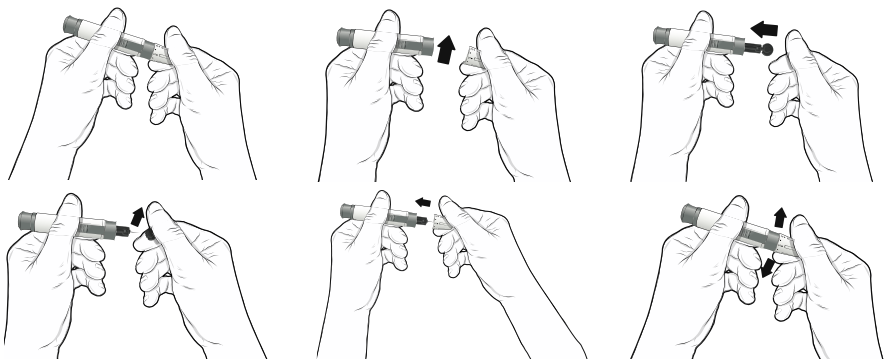

3. For starting the measurement, tap the **Start icon**, measurement starts after a short beep.



Back – return to the Dashboard.

History – all previous measurements displayed.

4. Remove a **test strip** from the **strip vial**. Tightly **close the vial cap** immediately after you have removed the test strip. **Insert the test strip** into **Glycemic Test Strips port** in the direction of the arrows.

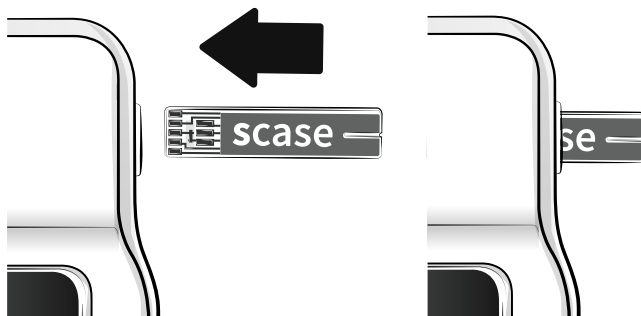

5. Simultaneously, on the screen a blue circle is **loading until the test strip is not inserted into the Glycemic Test Strips port**.



6. Press the Lancing device against the side of the finger to be lanced with the cover resting on the finger. Push the release button to prick your fingertip.

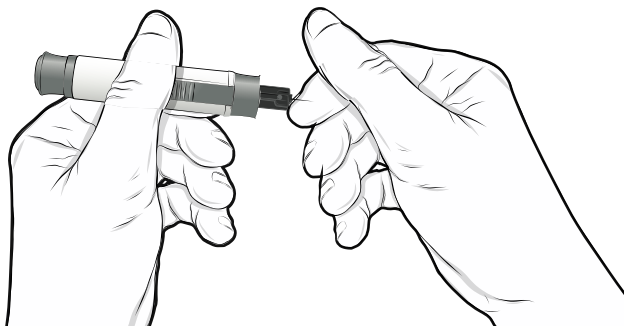

7. Immediately touch the tip of the test strip to the drop of blood. The blood pulled into the test strip through the tip. Make sure that the blood sample has been fully filled the check window on the strip tip.

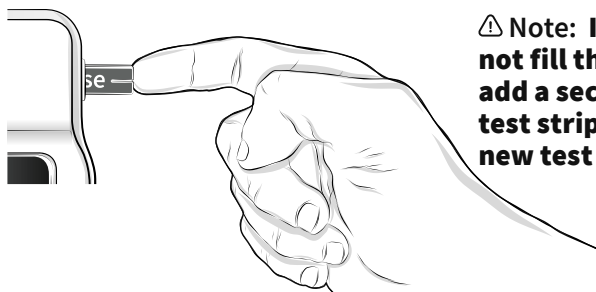

⚠ Note: If the blood sample does not fill the check window, do not add a second drop. Discard the test strip and start over with a new test strip.

8. Simultaneously, on the screen a blue circle is loading until the blood sample has fully filled the strip tip.





9. Wait, the measurement is processing. Once done, please answer whether you have eaten in last couple of hours



10. The screen shows the measurement results. Please note, you can discard your measurement by pressing . Measurement can be discarded within 10 second, until you hear a short beep.

Repeat Measurement – pressing the button  Repeat measurment you can repeat the measurement.

 **Back** – return to the Dashboard.

 **History** – all previous measurements displayed.

11. Discard the used test strip by hand.

⚠ Biohazard: **Dispose of the used test strips as medical waste.**

Expected Diabetes control goal:

Time	Range, mg/dL	Range, mmol/L
Before a meal	70 – 130	3.9 – 7.2
1-2 hours after beginning of the meal	Less than 180	Less than 10

8. Device description

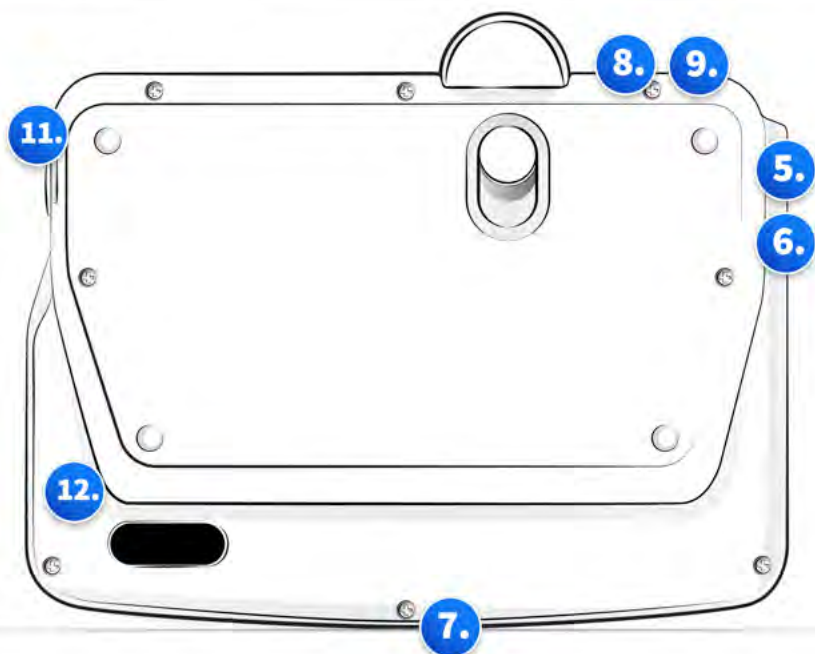
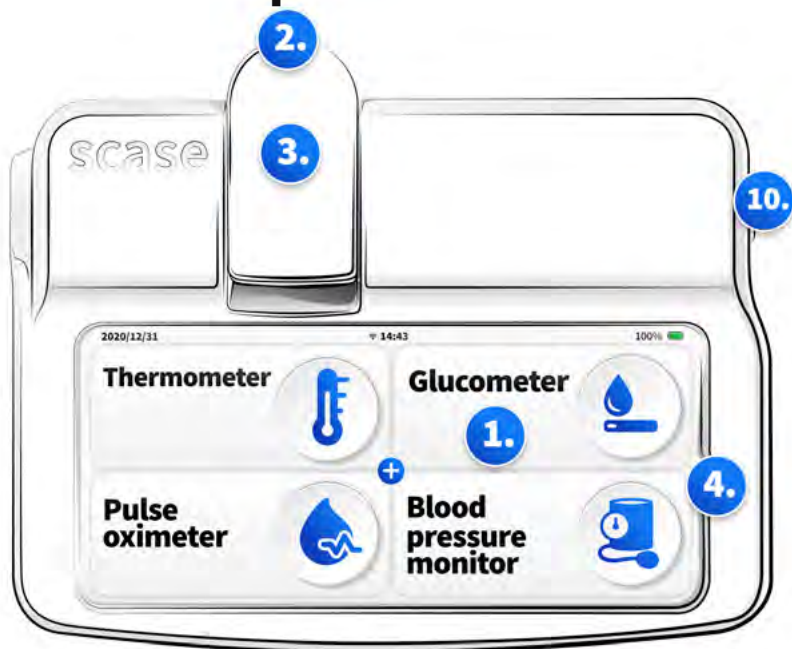

1. Touch Screen

2. Removable Pulse oximeter clamp

3. LED indicator (Pulse oximeter)

Blue: Ongoing measurement

Yellow: The battery of the Pulse oximeter clamp is low

Red: Error

4. Front Camera

5. Two Thermometer diodes

Diodes show the right position of Thermometer

6. Thermometer

7. Power On / Off button

When Scase Device is off,

press and hold this button for 2 seconds to turn it on.

When Scase Device is on,

press and hold this button for 2 seconds to turn it off.

When the Touch Screen is off, press this button to power it on.

When the Touch Screen is on,

press this button to get Scase Device to Standby Mode.

8. USB-C charging port

9. LED Indicator

Blue: Scase device is on

Yellow: Charging

Red: Error

10. Glycemic Test Strips port

11. Air Jack

12. Back Camera

9.Customer Support

Website link

Through chosen web browser click on: **www.scase.io/support** , choose your language and fill out necessary information. Your requirement will be solved as soon as possible.

QR code

Scan QR code below on your mobile phone, choose your language and fill out necessary information. Your requirement will be solved as soon as possible.





Online Support

www.scase.io/support/



scase 

Office: **Riazanská 19, Bratislava 831 03**

Domicile: **Štefana Kráľíka 7066/1A, Bratislava 841 07**

Business ID: 52573699 Tax ID: 2121083074 VAT reg: SK2121083074

www.scase.io info@scase.io