

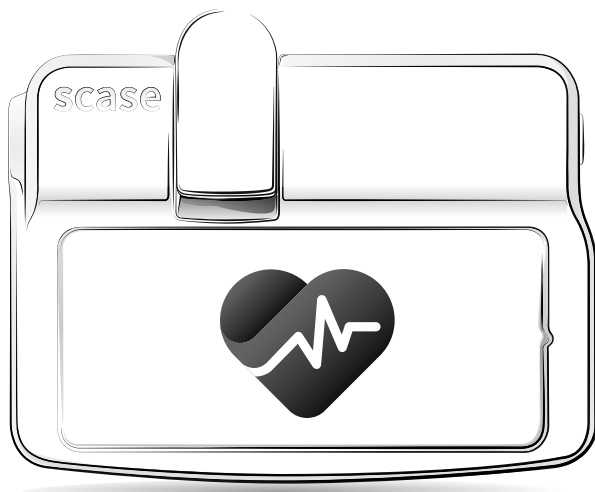

# User Manual

[www.scase.io/manuals/](http://www.scase.io/manuals/)





**User manual**

**Thank you  
For your participation**

⚠ Not intended for diagnostic use, nor prevention of disease

This device is provided under the Medical Device Directive COUNCIL DIRECTIVE 93/42/EEC of 14 June 1993 concerning medical devices under the Articles 4, 15 and Annex VII for Free movement, devices intended for special purposes

<b>1. About Scase Device</b>	<b>1</b>
<b>2. Thermometer</b>	<b>1</b>
Taking Temperature Measurement .....	1
<b>3. Pulse oximeter</b>	<b>3</b>
Taking Oxygen Saturation and Pulse Measurement .....	3
To start the Pulse oximeter measurement, .....	3
<b>4. Blood pressure monitor</b>	<b>4</b>
Taking Blood pressure measurement .....	4
<b>5. Glucometer</b>	<b>6</b>
Test Strip .....	6
Lancing Device .....	6
Preparing the Lancing device .....	6
Taking Blood glucose measurement .....	7
To start a Blood glucose measurement, .....	8
<b>6. Questionnaires</b>	<b>11</b>
About Questionnaires .....	11
Assigned Questionnaires .....	11
Receiving Questionnaire .....	12
<b>8. Device Description</b>	<b>16</b>
<b>9. Customer Support</b>	<b>18</b>
Website link .....	18
QR code .....	18

# 1. About Scase Device

Scase Device is intended to be used for measuring, displaying, reviewing, and storing of Blood Pressure, Oxygen Saturation, Pulse Rate, Blood Glucose Levels, Temperature of forehead or objects at home or in healthcare facilities. Values are saved automatically.

## 2. Thermometer

### Taking Temperature Measurement

To start a Temperature measurement,

**1. In the Dashboard, click the Thermometer button.**



**2. Click Start,** temperature measurement starts after a short beep.



**Back** – return to the Dashboard.

**Anonymous Measurement** – measurement will start right away and will not be assigned to your patient profile or recorded to the history. Result cannot be discarded.

**History** – all previous measurements are displayed.

3. Locate the **Thermometer** placed on the left side of Scase Device and place **in the middle of your forehead**.

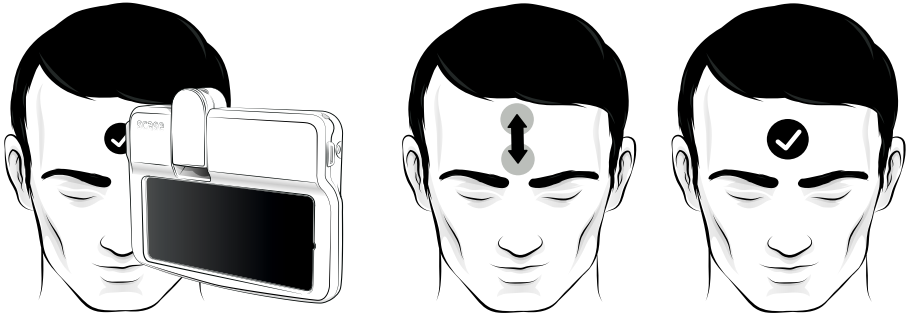

**Temperature measurement executed by someone else:**

Move Scase device / Thermometer sensor towards the middle of the patient's forehead, keep the device in horizontal position and wait until a single circle on the forehead is illuminated. Hold still. The circle marks the ideal measurement distance.

⚠ Note - **The sensor must be positioned correctly within 5 seconds after starting the measurement.**

4. Keep the sensor in **the middle of the forehead**. During the measurement, on the display, a **circle is slowly filled up**. Once the measurement is concluded, **you will hear a short beep**.

5. Take down the device, the screen shows the measurement results in °C. Please note, you can discard the measurement by pressing **Cancel measurement**. Measurement can be discarded within 10 second, until you hear a short beep.



**Back** – return to the Dashboard.

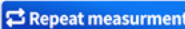

**Repeat measurement** - pressing the button, you can repeat the measurement.



**History** – all previous measurements are displayed

### 3. Pulse oximeter

#### Taking Oxygen Saturation and Pulse Measurement

To start the Pulse oximeter measurement,

**1. In the Dashboard, click the Pulse oximeter button.**



**2. Open the Pulse oximeter clamp and place the middle, ring or index finger into the rubber opening of the Pulse oximeter.**

**Nail of the finger must point upwards as in picture.**

⚠ Woman with small hands should use thumb

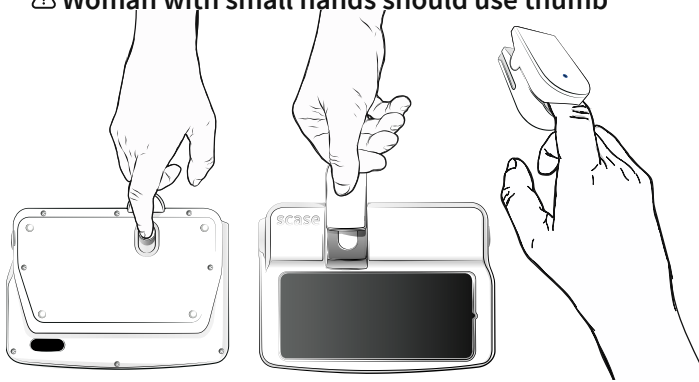

**3. Click Start, oxygen saturation measurement starts after a short beep.**



**Back** – return to the Dashboard.

**Anonymous Measurement** – measurement will start right away and will not be assigned to your patient profile or recorded to the history. Result cannot be discarded.

**History** – all previous measurements are displayed.

⚠ Note - **keep your hand still during the measurement.**

**4.** During the measurement, on the display, a circle is slowly filled up. Once the measurement is concluded, you will hear a short beep.

**5.** The screen shows the measurement result. Please note, you can discard the measurement by pressing **Cancel measurement**. Measurement can be discarded within 10 second, until you hear a short beep.



**Back** – return to the Dashboard.



**Repeat measurement** - pressing the button, you can repeat the measurement.



**History** – all previous measurements are displayed

## 4. Blood pressure monitor

### Taking Blood pressure measurement

To start a Blood pressure measurement,

**1. Wrap the cuff around the upper arm and plug the cuff cable to the Air Jack.**

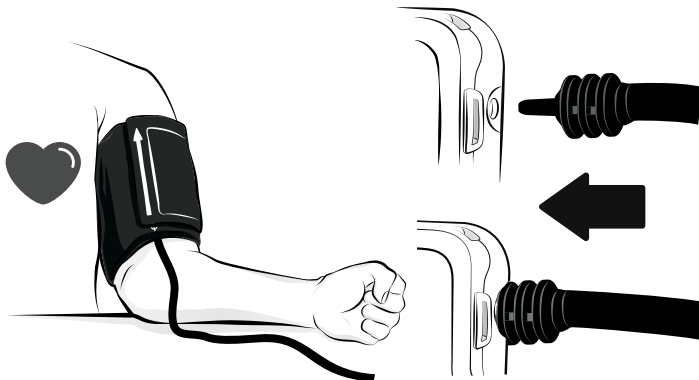

2. In the **Dashboard**, click the **Blood pressure monitor** button.



3. For starting the measurement, tap the **Start icon**.

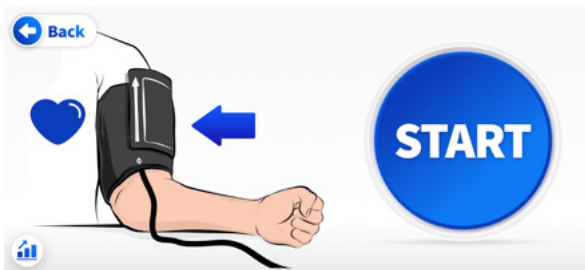

**Back** – return to the Dashboard.

**Anonymous Measurement** – measurement will start right away and will not be assigned to your patient profile or recorded to the history. Result cannot be discarded.

**History** – all previous measurements are displayed.

4. Measurement starts after a short beep and the pump begins to inflate the cuff.

5. During the measurement, on the display, a circle is slowly filled up. Once the measurement is concluded, you will hear a short beep.

6. The screens shows the measurement results. Please note, you can discard your measurement by pressing **Cancel measurement**. Measurement can be discarded within 10 second, until you hear a short beep.



**Back** – return to the Dashboard.

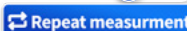

**Repeat measurement** - pressing the button, you can repeat the measurement.



**History** – all previous measurements are displayed



# 5. Glucometer

## Test Strip

**Electrode end:**  
This end inserted into the test strip port on the device facing up



**Sample tip:**  
Where the blood is drawn in

## Lancing Device

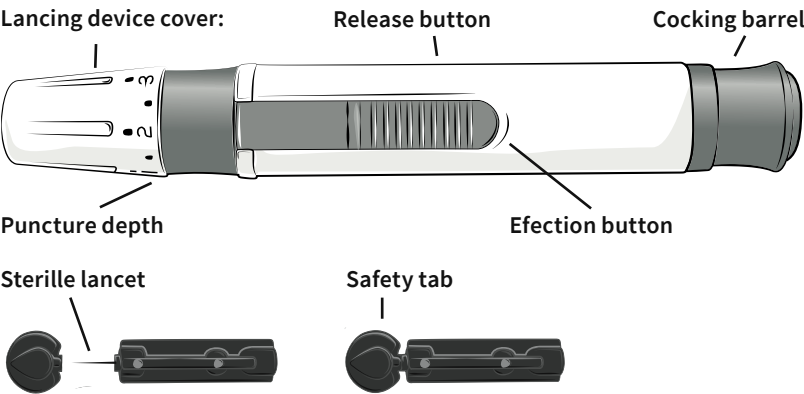

## Preparing the Lancing device

1. **Unscrew the Lancing device cover from the body of the Lancing device. Insert a sterile lancet into the Lancing device.**

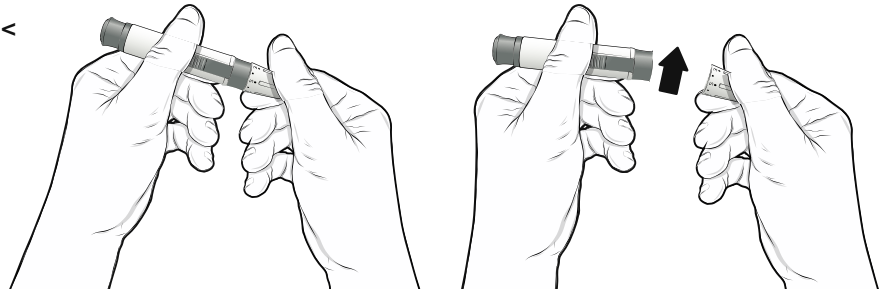

**2. Hold the lancet firmly in the Lancing device and twist the safety tab of the lancet until it loosens, then pull the safety tab off the lancet.**

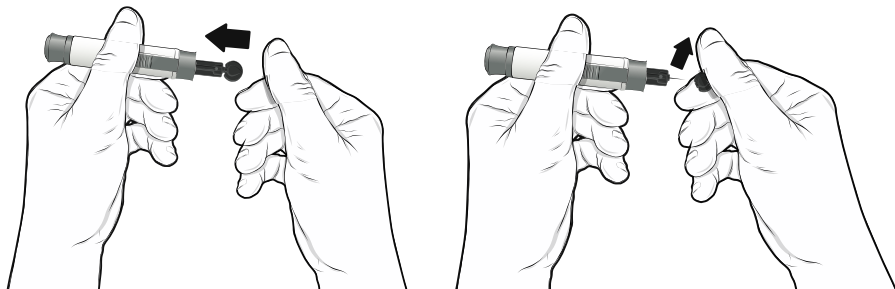

**3. Carefully screw the cover back onto the Lancing device.**

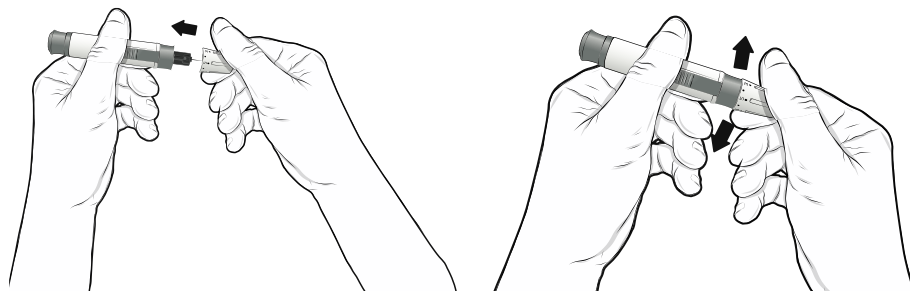

**4. Adjust the puncture depth by rotating the Lancing device cover.**

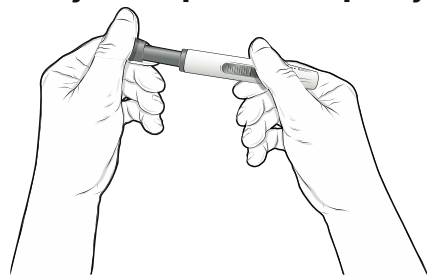

**5. Pull the cocking barrel back to set the Lancing device.**

## **Taking Blood glucose measurement**

**⚠ Important: Prior to testing, wipe the test site with an alcohol swab or soapy water. Use warm water to increase blood flow if necessary. Then dry your hands and test site thoroughly.**

## To start a Blood glucose measurement,

1. In the **Dashboard**, click the **Glucometer** button.



2. Follow the steps regarding preparing the Lancing device above.

3. For **starting the measurement**, tap the **Start** icon, measurement starts after a **short beep**.



**Back** – return to the Dashboard.

**Anonymous Measurement** – measurement will start right away and will not be assigned to your patient profile or recorded to the history. Result cannot be discarded.

**History** – all previous measurements are displayed.

4. **Remove a test strip from the strip vial.** Tightly close the vial cap immediately after you have removed the test strip. **Insert** the test strip into Glycemic **Test Strips port** in the direction of the arrows.

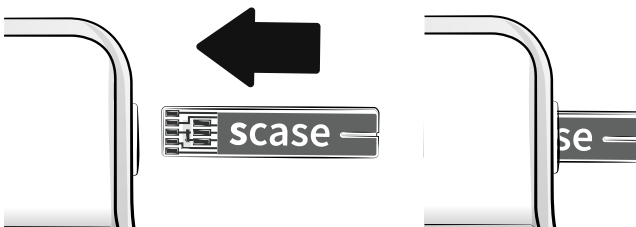

5. **Simultaneously**, on the screen a blue circle is loading until the test strip is not inserted **into the Glycemic Test Strips port**.



6. Press the **Lancing device** against the **side of the finger** to be lanced with the cover resting on the finger. **Push the release button** to prick your fingertip.

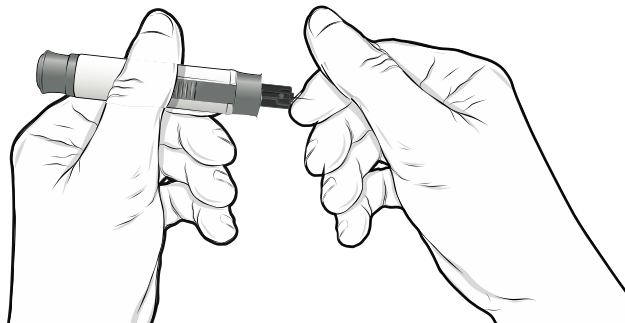

7. **Immediately touch the tip of the test strip to the drop of blood.** The blood pulled into the test strip through the tip. Make sure that the blood sample has been fully filled the check window on the strip tip.

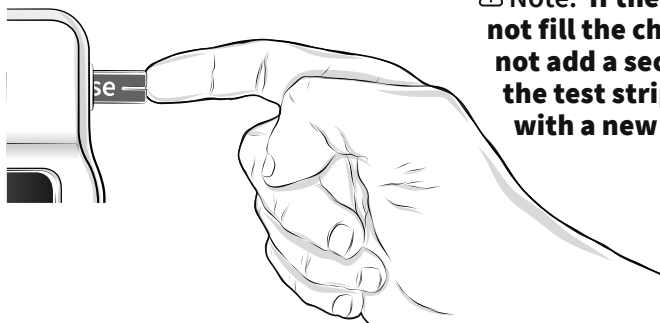

⚠ Note: If the blood sample does not fill the check window, do not add a second drop. Discard the test strip and start over with a new test strip.

8. **Simultaneously**, on the screen a **blue circle is loading until the blood sample has fully filled the strip tip.**

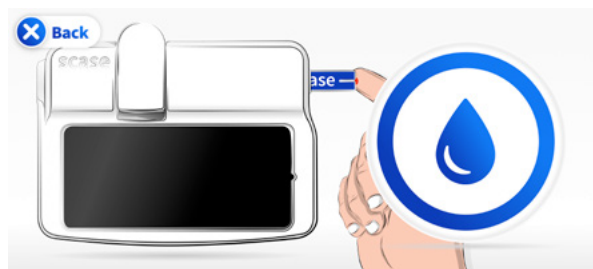

9. **Wait**, the measurement is processing. Once done, **please answer whether you have eaten in last couple of hours.**

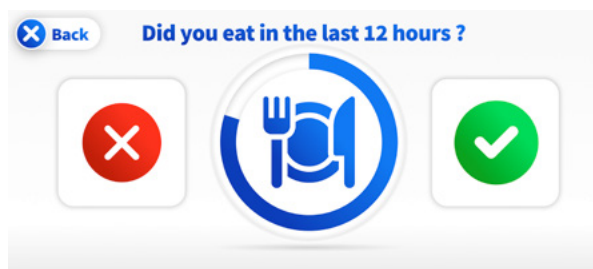

10. The screen shows the measurement results. Please note, you can discard your measurement by pressing **Cancel measurement**. Measurement can be discarded within 10 second, until you hear a **short beep**.



**Back** – return to the Dashboard.

**Repeat measurement** - pressing the button, you can repeat the measurement.



**History** – all previous measurements are displayed

## 12. Discard the used test strip by hand.

⚠ Potential Biohazard: **Dispose of the used test strips as medical waste.**

Expected Diabetes  
control goal:

Time	Range, mg/dL	Range, mmol/L
Before a meal	70 - 130	3.9 - 7.2
1-2 hours after beginning of the meal	Less than 180	Less than 10

# 6. Questionnaires

## About Questionnaires

Based on the specific needs and medical condition of the patient, a doctor will create a questionnaire containing questions that are asked the patient on a weekly basis during short phone calls / follow-up visits. Questionnaires will be shown on the screen of Scase Device.

### No Assigned Questionnaires



If there were no Questionnaires assigned for you by doctor, picture above will be shown.

By clicking  button, patient gets to the Menu screen.

## Assigned Questionnaires

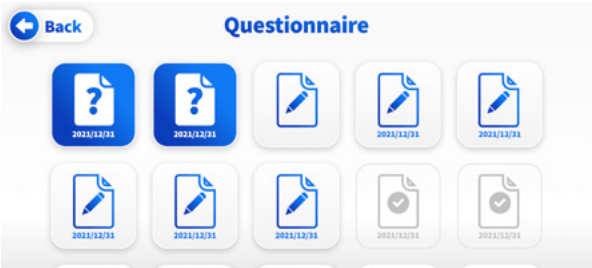

All assigned questionnaires are shown on the screen of Scase Device.



Questionnaire has not been opened or filled yet. After clicking this button, you can edit, finalize or save assigned Questionnaire for later time.



Questionnaire has been open, filled, but not sent by you back to doctor. After clicking this button, you can review, edit and finalize assigned questionnaire.





Questionnaire has been submitted to physician by you already. After clicking this button, you can review filled questionnaire.

By clicking  button, patient gets to the Menu screen.

## Receiving Questionnaire

1. According to your medical treatment, an independent Questionnaires will be recieved during the time of your remote telemonitoring by Scase Device from your physician. Every time you recieve the Questionnaire you will be alerted by signal shown below.



By clicking  , you will be transfered to available details of Questionnaire. By clicking  last attended screen will be displayed.

2. All details will be explained and you will be asked to filled up assigned Questionnaire.

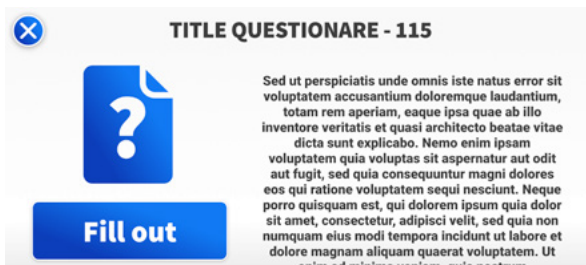

By clicking  , you will be able to filled up your unique Questionnaire right away.

By clicking  , you will get to all assigned Questionnaires.

### 3. Questionnaires can contain four types of questions:

**Multiple questions:** More than one answer can be submitted.  
By clicking  you will be transferred to the screen with all assigned Questionnaires.

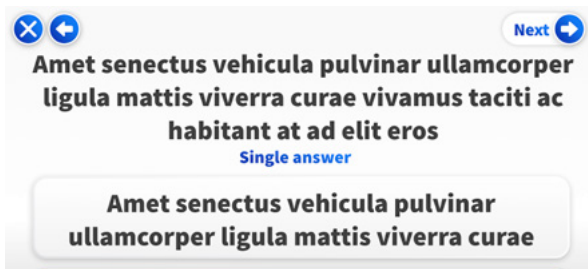

The screenshot shows a question interface with a light blue background. At the top left are two circular buttons: one with a blue 'X' and one with a blue left arrow. At the top right is a button labeled 'Next' with a blue right arrow. The question text is in a bold, black, serif font: 'Amet senectus vehicula pulvinar ullamcorper ligula mattis viverra curae vivamus taciti ac habitant at ad elit eros'. Below the question text is the label 'Single answer' in a smaller, blue, sans-serif font. At the bottom, there is a rounded rectangular input field containing the text 'Amet senectus vehicula pulvinar ullamcorper ligula mattis viverra curae'.

By clicking  button, you will be transferred to the previous shown screen.

By clicking  you will be transfered to another question.

**Single questions:** Only one answer can be submitted.

By clicking  you will be transferred to the screen with all assigned Questionnaires

By clicking  button, you will be transferred to the previous shown screen.

By clicking  you will be transfered to another question.

**Yes or No:** Please, answer the question by choosing Yes or No.

By clicking  you will be transferred to the screen with all assigned Questionnaires.

By clicking  button, you will be transferred to the previous shown screen.

By clicking  you will be transfered to another question.



**Subjective reply:** Your subjective opinion should be described, this will help your physician to better understand your health issue.

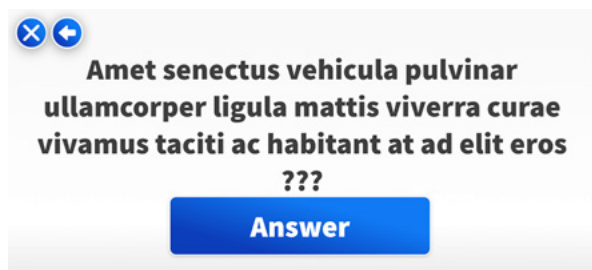

By clicking  you will be transferred to the screen with all assigned Questionnaires.

By clicking  button, you will be transferred to the previous shown screen.

By clicking  you can specify your answer.

**Please, shortly describe your answer by typing on Scase keyboard:**

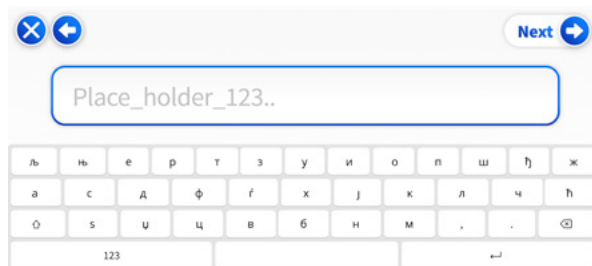

By clicking  you will be transferred to the screen with all assigned Questionnaires

By clicking  button, you will be transferred to the previous shown screen.

By clicking  you will be transferred to another question

**4. After replying all questions, you are notified and screen below is shown.**

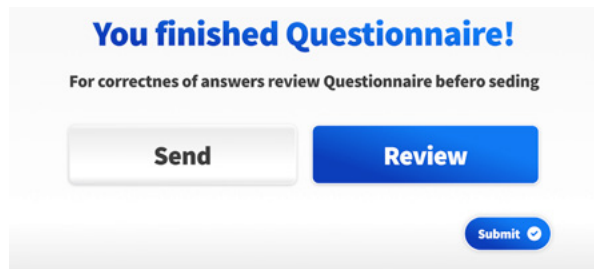



**You finished Questionnaire!**

For correctnes of answers review Questionnaire befero seding

**Send** **Review**

**Submit** ✓

By clicking  you can submit the Questionnaire without a possibility of additional check.

By clicking  you can check and edit your replies before submitting the questionnaire to your physician.

By clicking  confirm your choice.

## 8. Device Description

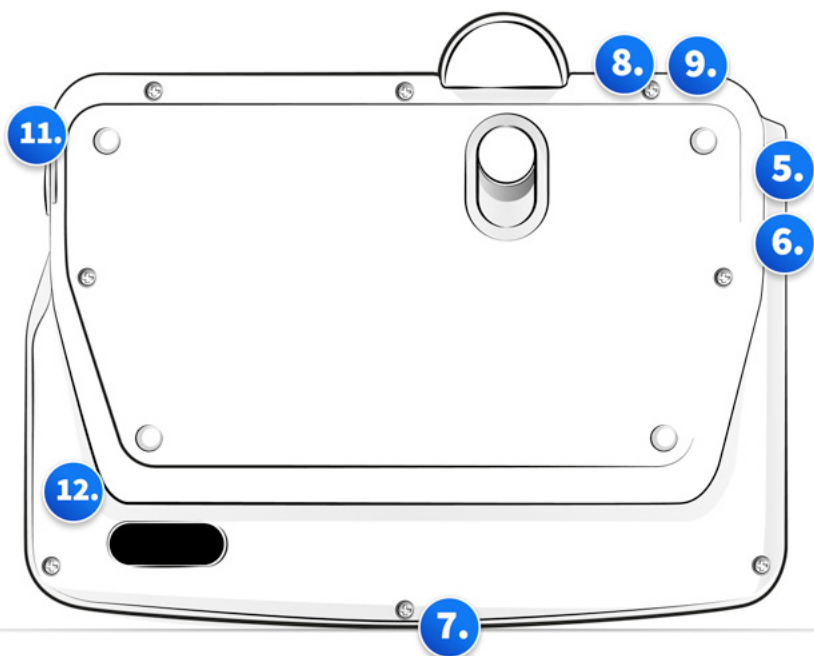
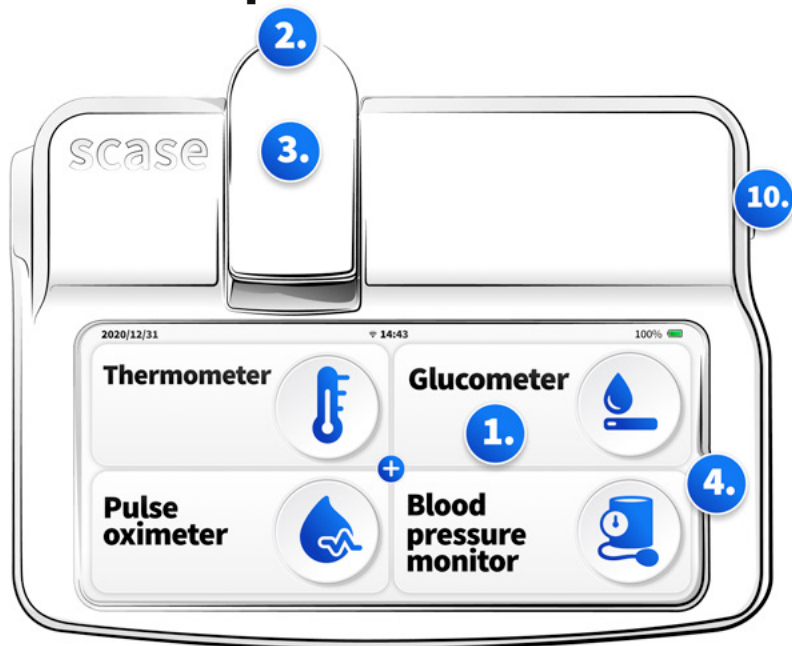

## **1. Touch Screen**

## **2. Removable Pulse oximeter clamp**

## **3. LED indicator (Pulse oximeter)**

Blue: Ongoing measurement

Yellow: The battery of the Pulse oximeter clamp is low

Red: Error

## **4. Front Camera**

## **5. Two Thermometer diodes**

Diodes show the right position of Thermometer

## **6. Thermometer**

## **7. Power On / Off button**

When Scase Device is off,

press and hold this button for 2 seconds to turn it on.

When Scase Device is on,

press and hold this button for 2 seconds to turn it off.

When the Touch Screen is off, press this button to power it on.

When the Touch Screen is on,

press this button to get Scase Device to Standby Mode.

## **8. USB-C charging port**

## **9. LED Indicator**

Blue: Scase device is on

Yellow: Charging

Red: Error

## **10. Glycemic Test Strips port**

## **11. Air Jack**

## **12. Back Camera**

## 9.Customer Support

### Website link

Through chosen web browser click on: **[www.scase.io/support](http://www.scase.io/support)** , choose your language and fill out necessary information. Your requirement will be solved as soon as possible.

### QR code

Scan QR code below on your mobile phone, choose your language and fill out necessary information. Your requirement will be solved as soon as possible.





# Online Support

[www.scase.io/support/](http://www.scase.io/support/)



**scase** 

Office: **Riazanská 19, Bratislava 831 03**

Domicile: **Štefana Kráľíka 7066/1A, Bratislava 841 07**

Business ID: 52573699 Tax ID: 2121083074 VAT reg: SK2121083074

[www.scase.io](http://www.scase.io) [info@scase.io](mailto:info@scase.io)